



MODELS:

Voltage	Output	Protection Class	Cable with Plug	Outlets Sockets	Weight without Cable	Order No.
24 V AC / 50 HZ	44 W	IP54	5 m 10 m	- none -	2.28 kg	QVL2440/5 QVL2440/10
		IP44	5 m 10 m	1 CEE 24V 16A, 2 pol.	2.40 kg	QVL2440/5/1 QVL2440/10/1
42 V AC / 50 HZ		IP54	5 m 10 m	- none -	2.28 kg	QVL4240/5 QVL4240/10
		IP44	5 m 10 m	1 CEE 42V 16A, 2 pol.	2.40 kg	QVL4240/5/1 QVL4240/10/1
230 V / 50 HZ		IP54	5 m 10 m	- none -	2.45 kg	QVL2340/5 QVL2340/10
		IP54	5 m 10 m	3 earthing contact sockets	2.54 kg	QVL2340/5/03 QVL2340/10/03

SPECIAL FEATURES:

- dimensions (WxHxD): 280 x 360 x 130 mm
- limited weight
- LED panel with highly efficient SMD LEDs
- housing made of impact-resistant polycarbonate, edge protector of soft, thermoplastic elastomer
- handle made of impact-resistant ABS with 6 locking positions for positioning
- incl. robust switch on the lamp
- low heat development
- limited space required, flat and compact form
- easy and trouble-free handling while in use
- LED panel with high light output, 6,450 lm, with low energy consumption, COST SAVINGS
- strongly suitable for mobile use on building and construction sites
- simple to transport, can be set up versatily and in all situations
- can be switched on and off directly at the workplace
- no burns when touched, SAFETY

battery model on page 22.01

– other cable lengths and models on request / subject to modification and errors –



Tripod type BETA 3

ACCESSORIES:

- Tripod Type BETA 3 with \varnothing 30 mm DIN pins
- black aluminum
- height when folded: 114 cm
- maximum height when set up: 252 cm
- minimum height when set up: 96 cm
- diameter of the maximum footprint: 114 cm
- max. load capacity: ca. 30 kg
- tripod weight: ca. 6.5 kg
- completely preassembled

Order No.

TV7521SA

- basic mounting bracket for attaching the support bar with a 30 mm DIN pin

TV001

- 1-panel support bar

QVL001

- Magnetic mount for 1 piece QVLED40 (2 large magnets with support rail)

QVL01M2

REPLACEMENT PARTS:

- front section in anthracite/blue
- cover panel
- rear housing with 3 earthing contact sockets and switch
- rear housing without sockets but with switch
- handle
- LED panel
- LED converter 230 V
- LED converter 24 V AC
- LED converter 42 V AC

Order No.

QVL003

QVL004

QVL005

QVL006

QVL007

QVL008

QVL009

QVL010

QVL011



Basic mount TV001

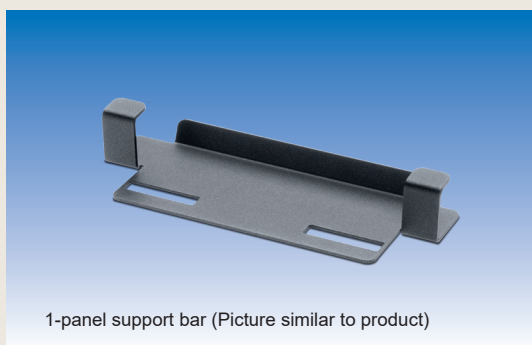

1-panel support bar (Picture similar to product)

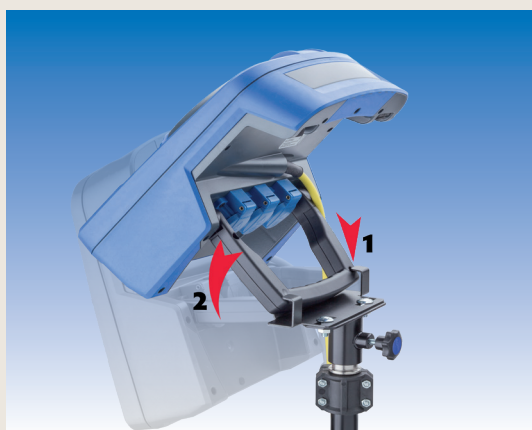

– other tripods and cross bars are found starting on page 13.1 / subject to modification and errors –